

RETAIL  
FOR LEASE

# College Park Retail Space

1313 Edgewater Dr. Orlando, FL 32804



LEASE RATE  
**\$18 PSF**

Located in the heart of vibrant College Park, this recently renovated space features incredible access to downtown Orlando and I-4. This former dance studio boasts a flexible wide open center space and 3 offices. Its popular Edgewater Drive location provides 15,700 vehicles of daily traffic.

## Property Details

Building Size:	±1392 SF
Rentable Square Footage:	±1392 SF
Primary Type:	Retail
Additional Type:	Office
Stories:	One
Year Built / Age:	1,952/68
Signage:	Building Front
Number of Offices:	3
Traffic Count:	15,700 Vehicles / Day

## Property Highlights

- Excellent access to Downtown Orlando
- Walkable College Park Community
- Edgewater Drive frontage
- Minutes from I-4 and Colonial Drive

## Location

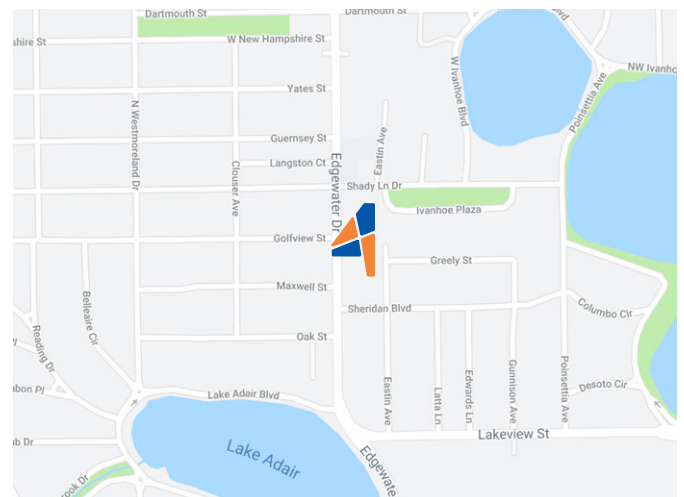

	1 Mile	3 Miles	5 Miles
Population	11,519	87,563	284,445
Households	5,830	42,325	119,507
Average HHI	\$106,861	\$88,158	\$77,806

PRESENTED BY

Nicholas Fouraker CCIM

NICK@4ACRE.COM | 407.601.1466

CALL  
FOR MORE  
INFORMATION

4 Acre Commercial Real Estate (4 Acre) does not represent or warranty the accuracy of the information contained herein. Such information has been given to 4 Acre by the owner of the property or obtained from other sources deemed reliable. 4 Acre has no reason to doubt its accuracy, but does not guarantee it. The reviewer(s) of this document is encouraged to perform their own research to verify the dependability of the information being reviewed. All information should be verified by reviewer(s) prior to purchase or lease. Unless otherwise noted, the property is being offered as-is, where is, with all faults.

ADDITIONAL  
PHOTOS

# College Park Buildings

1313-1315 Edgewater Dr. Orlando, FL 32804



1313 Edgewater Dr.

±1,392 SF

Former Dance Studio



PRESENTED BY

Nicholas Fouraker CCIM

NICK@4ACRE.COM | 407.601.1466

CALL  
FOR MORE  
INFORMATION

4 Acre Commercial Real Estate (4 Acre) does not represent or warranty the accuracy of the information contained herein. Such information has been given to 4 Acre by the owner of the property or obtained from other sources deemed reliable. 4 Acre has no reason to doubt its accuracy, but does not guarantee it. The reviewer(s) of this document is encouraged to perform their own research for their own purposes to verify the dependability of the information being reviewed. All information should be verified by reviewer(s) prior to purchase or lease. Unless otherwise noted, the property is being offered as-is, where is, with all faults.

## 1313 Edgewater Dr. Floor Plan

±1,392 SF

Former Dance Studio

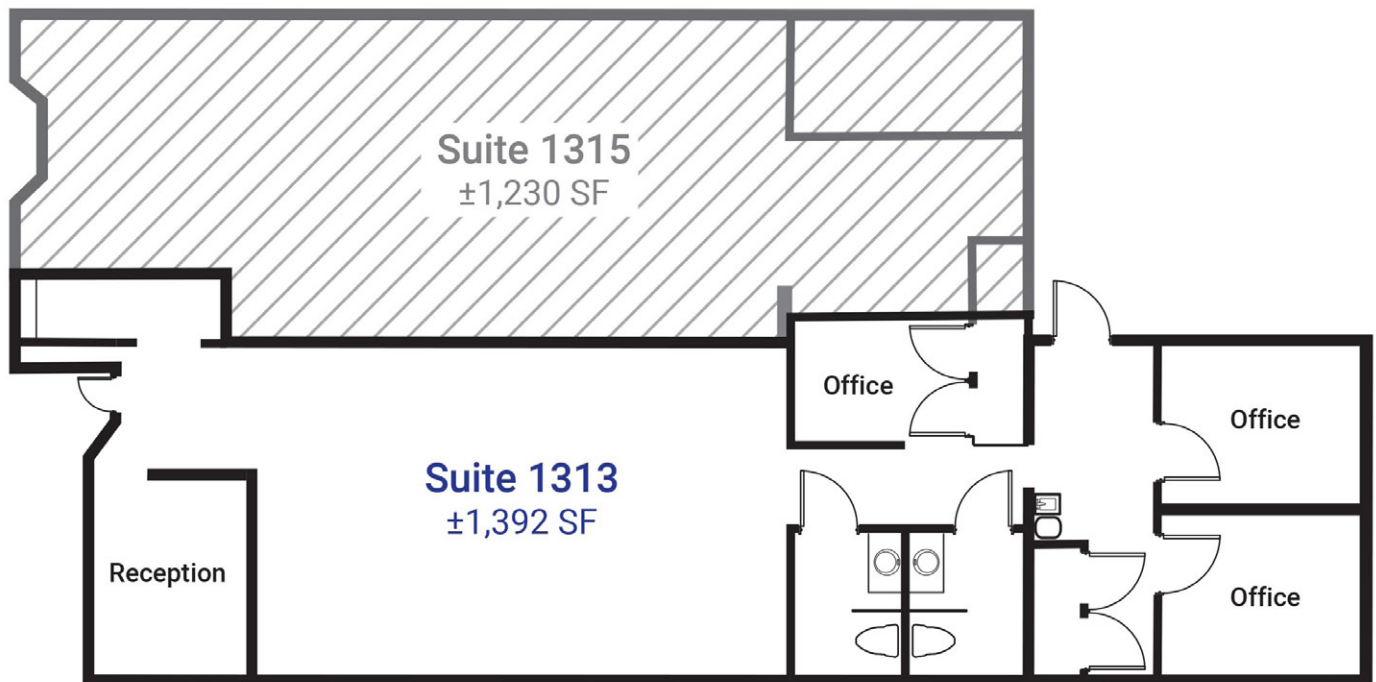

PRESENTED BY

Nicholas Fouraker CCIM

NICK@4ACRE.COM | 407.601.1466

CALL  
FOR MORE  
INFORMATION

POINTS OF  
INTEREST

College Park Buildings  
1313-1315 Edgewater Dr. Orlando, FL 32804



Sampling of National & Regional Points of Interest within 1 mile of property



NATIONAL



REGIONAL



PRESENTED BY

Nicholas Fouraker CCIM

NICK@4ACRE.COM | 407.601.1466

CALL  
FOR MORE  
INFORMATION

4 Acre Commercial Real Estate (4 Acre) does not represent or warranty the accuracy of the information contained herein. Such information has been given to 4 Acre by the owner of the property or obtained from other sources deemed reliable. 4 Acre has no reason to doubt its accuracy, but does not guarantee it. The reviewer(s) of this document is encouraged to perform their own research for their own purposes to verify the dependability of the information being reviewed. All information should be verified by reviewer(s) prior to purchase or lease. Unless otherwise noted, the property is being offered as-is, where is, with all faults.

LOCATION  
**AERIAL**

**College Park Buildings**  
1313-1315 Edgewater Dr. Orlando, FL 32804



## Sampling of National & Regional Points of Interest within 1 mile of property



PRESENTED BY

**Nicholas Fouraker CCIM**

**NICK@4ACRE.COM | 407.601.1466**

**CALL  
FOR MORE  
INFORMATION**